

| Part Number |
|-------------|
| PP606 |

Allen Field Company, Inc.

1450 Bridgewater Rd.
Bensalem, PA 19020
(800) 535-0810
www.allenfield.com

Product Images

Female, with a squared off flange corner, is inserted from the inside of the box.

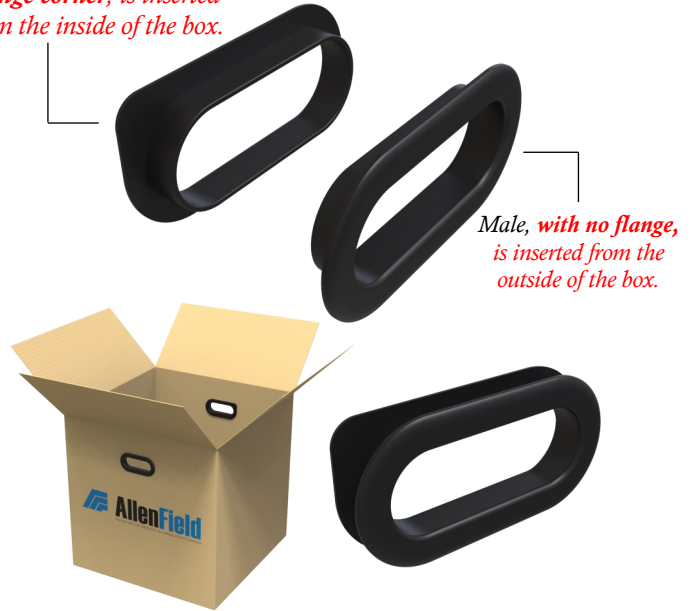

| Product Description | |
|-------------------------|----------------------------|
| Item Name | Two-Part Ellipse Hand Hole |
| Size | 4.45"(L) x 2.29"(W) |
| Maximum Board Thickness | .563" |
| Material | PP |
| Ordering Information | |
| PP606-10 | White |
| PP606-80 | Black |
| Packaging Information | |
| Carton Pack/MOQ | 400 sets/ctn. (800 pcs.) |
| Carton Weight | 27 lbs. |

Product Dimensions

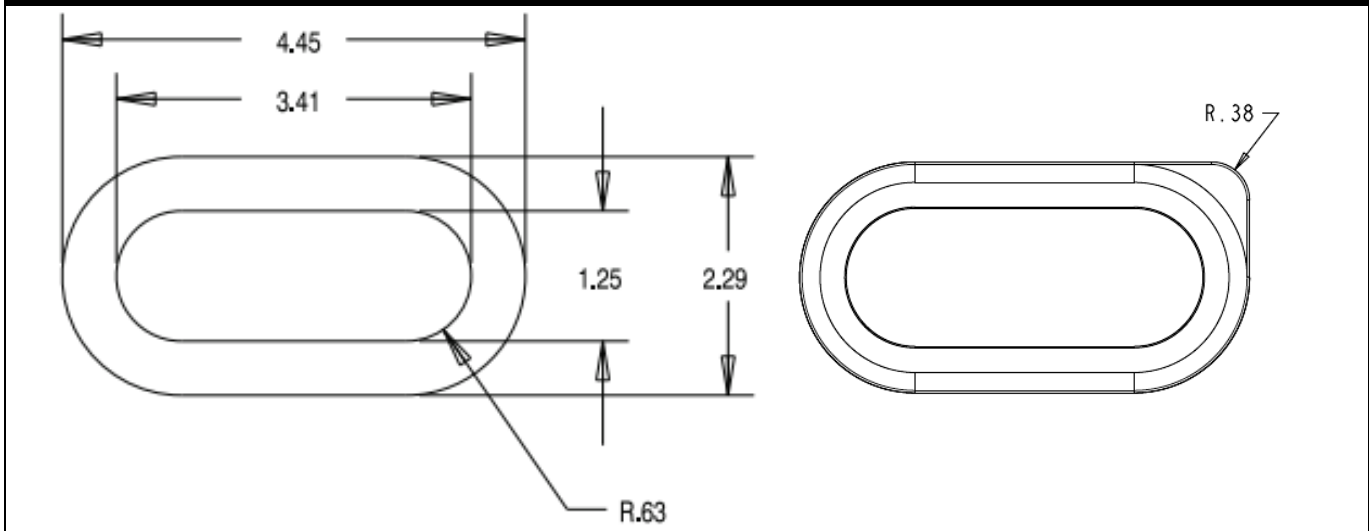

Die-Cut Dimensions (Type 3)

